



OPERATION

1. Turn off the battery charger, disconnect the charger's plug from the battery and attach the battery to the machine **1**.
2. Pull out the locking bolt **2** and lift the tank cap **3** up and release the locking bolt. Remove the fresh water tank **4** and fill the tank (max 50°C). The fresh water tank is inserted in the reverse order.
3. Fold up the stand for the park position **5**. Lower the squeegee **6** with the footrest **7**.
4. Press the ON/OFF button **8** for approx. 3 sec. The machine is ready to use. Press the ON/OFF button again, suction function **9** is switched on.
5. Hold the handle and release the rotary lock **10**, brush motor and water switches on.
6. Push the machine in the desired direction. Adjust the fresh water with the button **11** (if necessary).
7. For more cleaning performance, switch off the ECO mode with button **12**.

Note! Make sure that pad/brush is installed!

Qualified persons only are authorised to operate the machine!

The machine is not designed for coarse material, sweep the floor first!
Use only cleaning agents suitable for automatic machines! (low foaming)

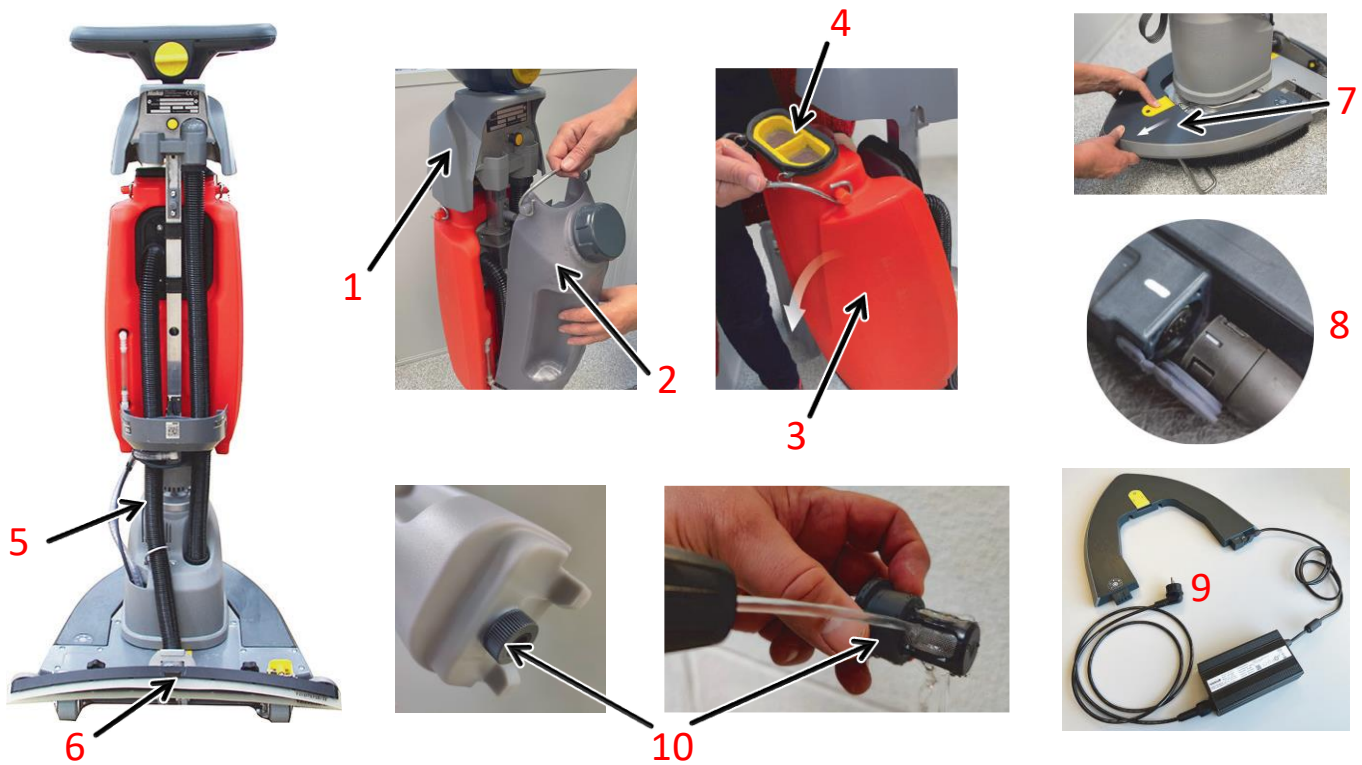

MAINTENANCE AND CARE

Daily maintenance:

- Turn off the machine.
- Lift the tank cap **1** up, remove and empty the fresh water tank **2**.
- Remove the dirty water tank **3**. Empty and clean the tank.
- Check and clean the sieve insert **4** thoroughly
- Disconnect and clean the suction hose **5**.
- Remove and clean the squeegee **6**.
- Tilt the machine and remove brushes/pads. Clean the brushes/pads or replace them if worn.
- Remove the battery **7** and insert the chargers plug to the battery. NOTE! Observe correct position of the charging plug using the white line **8**! Insert the mains plug **9** into a socket.

Weekly maintenance:

- Unscrew and remove the fresh water filter **10** and clean it
- Clean the machine from outside
- Check the sealing strips **6** and turn or replace them if necessary.

Suction result is bad:

- suction hose **5** or squeegee **6** is blocked
- The tank cap **1** is open.

Turn off the machine before maintenance!
Please pay attention to the informations in the instruction manual, you can find the manual by reading QR-code.

